

Tube connector for Sail / maindrop

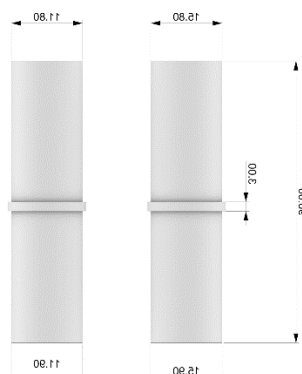

Tube connectors are made in:

Characteristic: Durable, Flexible, rigid, less moisture absorbing

Color: Natural

Manufacturing method by: C & C cutting

HPME 500 (High Molecular Polyethylene) Is a very wear-resistant plastic, retains its shape, has a low coefficient of friction and does not absorb moisture. This makes it extremely suitable for suitable shapes. The material is very easy to process mechanically.

Art-nr. 60.2016 / Art-nr. 60.16.12