

Keder Track Feeder

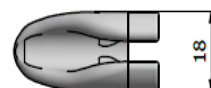
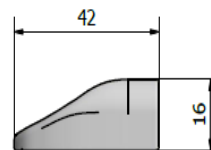

Connectors for kedertracks are made in:

Characteristic: Durable, Hard, Dimensionally stable, High melting temperature for Single Kedertrack 8.5mm

Color: Black and White

Manufacturing method by: Hot mold infusion

ABS (Acrylonitrile Butadiene Styrene) is an impact resistant engineering thermoplastic. It is an amorphous polymer. It is made of three monomers: acrylonitrile, butadiene and styrene. Due to its physical properties, it is preferred for structural applications. These properties include high rigidity, resistance to shock, wear and tension. Used in electronic housings, auto parts, consumer products, pipe fittings and lego toys.

Art-nr. 40.12.01W / Art-nr. 40.12.03B